

RIGHT OF WAY OF THE MAIN CHANNEL

- PARKS/RECREATION
- LEASED
- VACANT
- CORPORATE USE
- WATERWAYS

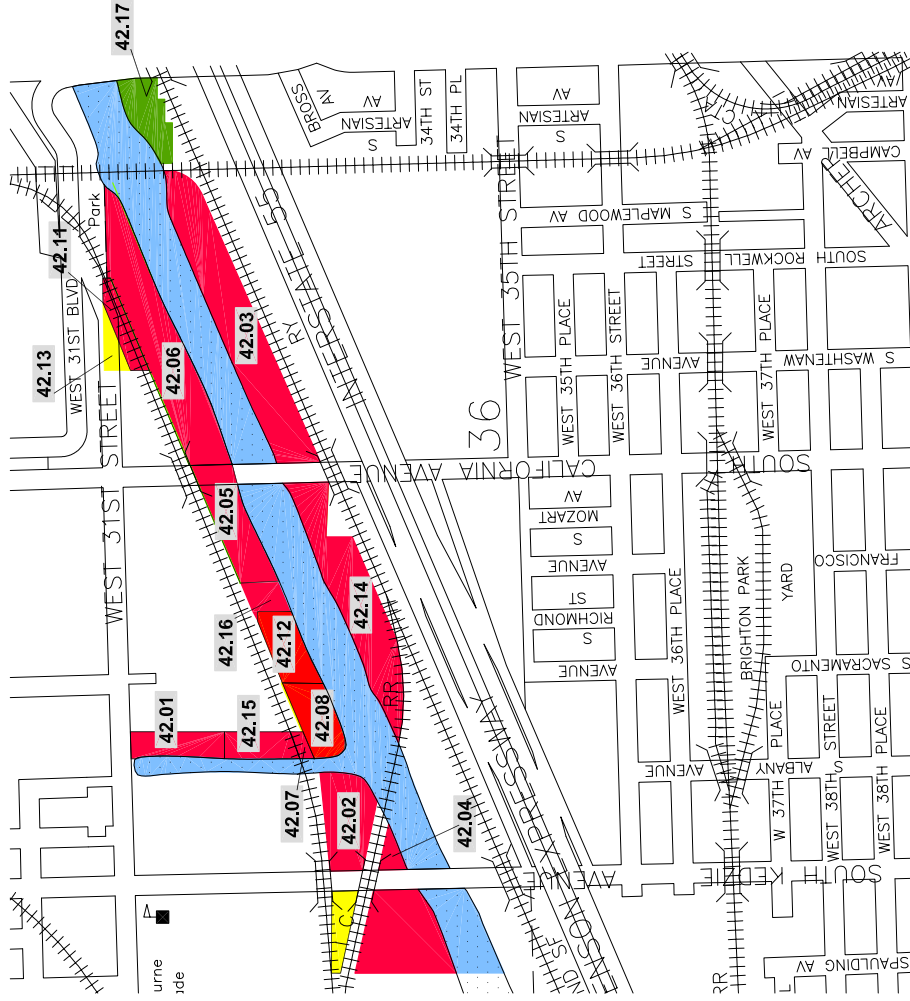

Index No.	Permittee or Lessee	Lease/Perm.#	Acres Leased	Terms of Lease	Remarks
42.01	City of Chicago	NL-024	2.05	04-01-14 to 03-31-2013	-
42.02	Apex Fuel Company	NL-208	4.50	08-01-92 to 07-31-2002	-
42.03	Ameropan Oil Company	NL-143	11.66	10-01-15 to 09-30-2014	-
42.04	Benchmark Const., Co., Inc.	NL-241	0.68	03-01-01 to 06-01-2040	-
42.05	Connelly, Inc.	NL-043	4.63	05-01-18 to 04-30-2017	-
42.06	California Auto Reclamation	NL-017	11.97	06-01-18 to 05-31-2017	-
42.07	Chgo. & Illinois West R. Co.	NL-028	0.52	07-01-58 to 06-30-2008	-
42.08	Recycling Systems, Inc.	NL-234	3.49	07-15-00 to 06-14-2039	-
42.09	Deleted	-	-	-	-
42.10	Deleted	-	-	-	-
42.11	Chgo. & Illinois West. R.R. Co.	NL-027	1.19	01-01-57 to 12-31-2006	-
42.12	Recycling Systems, Inc.	NL-234	4.63	07-15-00 to 06-14-2039	*Both Parcels
42.13	Vacant	-	0.59	-	-
42.14	Prairie Material Sales, Inc.	NL-107	8.42	03-01-38 to 02-28-2013	-
42.15	Nabisco, Inc.	NL-024A	2.3	03-01-92 to 03-31-2013	-
42.16	Connelly G.P.M.	NL-029	1.32	02-01-99 to 04-30-2017	-
42.17	Chicago Park District	NL#N/A	2.67	09-05-02 to 09-04-2041	-

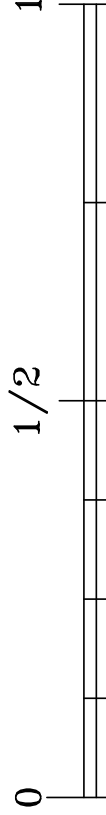

SCALE OF MILES